

By Appointment
to Her Majesty the Queen
Manufacturers of Motor Mowers:
Charles H. Pugh Ltd., Derby.



By Appointment
to H.R.H. The Prince of Wales
Manufacturers of Motor Mowers:
Charles H. Pugh Ltd., Derby.

ATCO

LAWN SWEEPER 30"



OPERATING INSTRUCTIONS

SWEEPER ASSEMBLY

GRASSBAG ASSEMBLY

Firstly unfold the grassbag (No. 27) with the base lying flat on the ground.

Slide the base support bar (No. 14) through the hollow section at the front of the grassbag.

Fit both the base supports (No. 16 & 62) to the rear support (No. 17) and lay in the base of the grassbag.

Slide both of the frame sides (Nos. 19 & 29) through the retaining tubes in the grassbag side and fit the rear support (No. 17) whilst the frame sides are in situ.

Locate the frame sides and base supports onto the base support bar and fix with three nuts (No. 15) per side as shown (see illustration).

Push fit handle (No. 28) to the handle sides (No. 20).

It is now necessary to fold the material over hole B and pivot A, and using a sharp pair of scissors cut a small slot, to allow A to protrude through the bag and provide access for the bolt through the frame side.

Fix the handle assembly onto the frame sides using bolts (No. 21), washer (No.22) and lock nuts (No. 23). Making sure wire support (No. 26) is positioned correctly (see illustration).

Using plastic clips (No. 25) fix the deflector shield of the grassbag to the support wire.

DRAW BAR ASSEMBLY

Assemble both draw bars together (Nos. 47 & 49) using the pivot pin (No. 58), washer (No. 8) and split pin (No. 7) provided.

Fit both the side supports to the delivery box assembly as shown in the illustration. Secure these using the side pins (No. 59), washers (No. 22) and split pins (No. 7) provided.

Position the draw bars into the retaining bracket on the side supports and secure with the two remaining pivot pins (see illustration).

The connecting bar (No. 66) should then be positioned over the top crossbar of the wheel guard assembly (No. 44) and retained using the spacer arrangement shown (see illustration).

OPERATION

HITCHING TO TRACTOR

The towing eye of the sweeper should be located onto the tractor as shown in fig. 1.

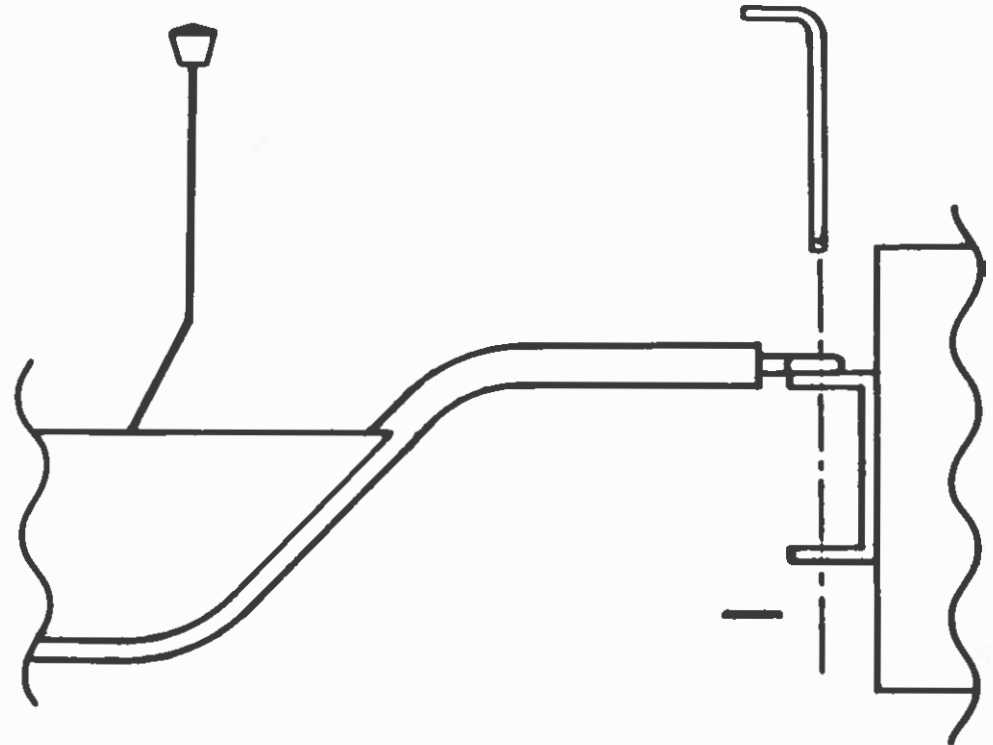

Adjustment might be required in setting the height of the hitch on the tractor so as to allow the sweeper to sit level. (See tractor handbook).

BRUSH HEIGHT ADJUSTMENT

When starting to sweep, set the brush to a height which is thought to be in excess of what is required. Drive forward on the tractor. If the unit does not pick up satisfactorily lower the height of cut by one notch and repeat the operation. When satisfactory collecting occurs, proceed.

NOTE:— To prolong brush and unit life never use the brush lower than is required to give a satisfactory collecting action. Whilst transporting from site to site raise the brush to its maximum height.

EMPTYING THE GRASSBAG

When the grassbag is full, drive to a convenient "dumping" site. Whilst pulling the handle crossbar forward (so as to lift grassbag into the vertical position) slowly drive forward. The bag will then discharge any clippings, etc. Once the grassbag is empty push back on the handle crossbar and the grassbag will swing into its operating position.

TROUBLE SHOOTING

TROUBLE	OBSERVATIONS	REMEDY
Brush does not collect adequately	Height of brush is excessive	Readjust brush height
Wheel skid on ground causing sweeper to 'judder'	Height of brush is too low	Readjust brush height
Brush fails to turn	Damaged or worn gearwheel assembly	Replace damaged gearwheel
	Damaged or worn pinion	Replace damaged pinion
	Both brush fixing screws missing	Replace screws, nuts and washers

MAINTENANCE

BRUSH ASSEMBLY REPLACEMENT

To remove the brush assembly (Part No. 32) it will be necessary to remove both wheels as follows:—

- 1 Remove the spring clips and shim washers which retain the wheel assemblies to the axles, and remove the said assemblies.
- 2 Remove the screws and locknuts which locate the brush assembly to the drive axles (these can be found inside the delivery box assembly Part No. 11).
- 3 Slide the drive axle together with pinion, clear of the brush tube.
- 4 Once the above steps have been carried out on both sides of the sweeper the brush can be dropped through the bottom of the delivery box assembly.
- 5 Replacement procedures for the brush are in reverse to that of removal.

LUBRICATION

For best results in performance it is necessary to remove both wheels, and oil the wheel axles and drives on both sides. This should be done with a light oil after each twenty hours of use, this should also be done if the Sweeper is stored for long periods.

STORAGE

- 1 The Sweeper should be thoroughly cleaned, removing all debris from the brush assembly and bag. Wipe down the delivery box with a soft cloth making sure it is both clean and dry, inside and out.
- 2 Protect all exposed metal surfaces with a light film of oil.
- 3 Check that all nuts, bolts, etc. are tight.
- 4 The grassbag and frame assembly should be stored in the vertical position. Support the handle in two positions.
- 5 Both sweeper unit and bag assembly should be stored in a dry covered area, and covered for additional protection.
- 6 At the beginning of each new season, remove the wheels and grease both pinions and gearwheels.

WARRANTY, SERVICE AND SPARES

Warranty is according to the details stated on the accompanying guarantee.

If you require assistance, service or replacement parts you should contact your nearest Service and Parts Centre or approved Service Agent listed in the "After Sales Service" leaflet supplied with your sweeper.

When ordering spares always give the following information (do not use the illustration reference number):—

- the part number
- the part name
- the quantity required

Where parts are made left hand (LH) and right hand (RH) these are viewed from behind the sweeper.

Every effort is made to ensure that this booklet is up-to-date. However, due to our policy of continued product development, changes in production specification may have been made. If in doubt, contact your nearest authorised dealer, or this company direct.

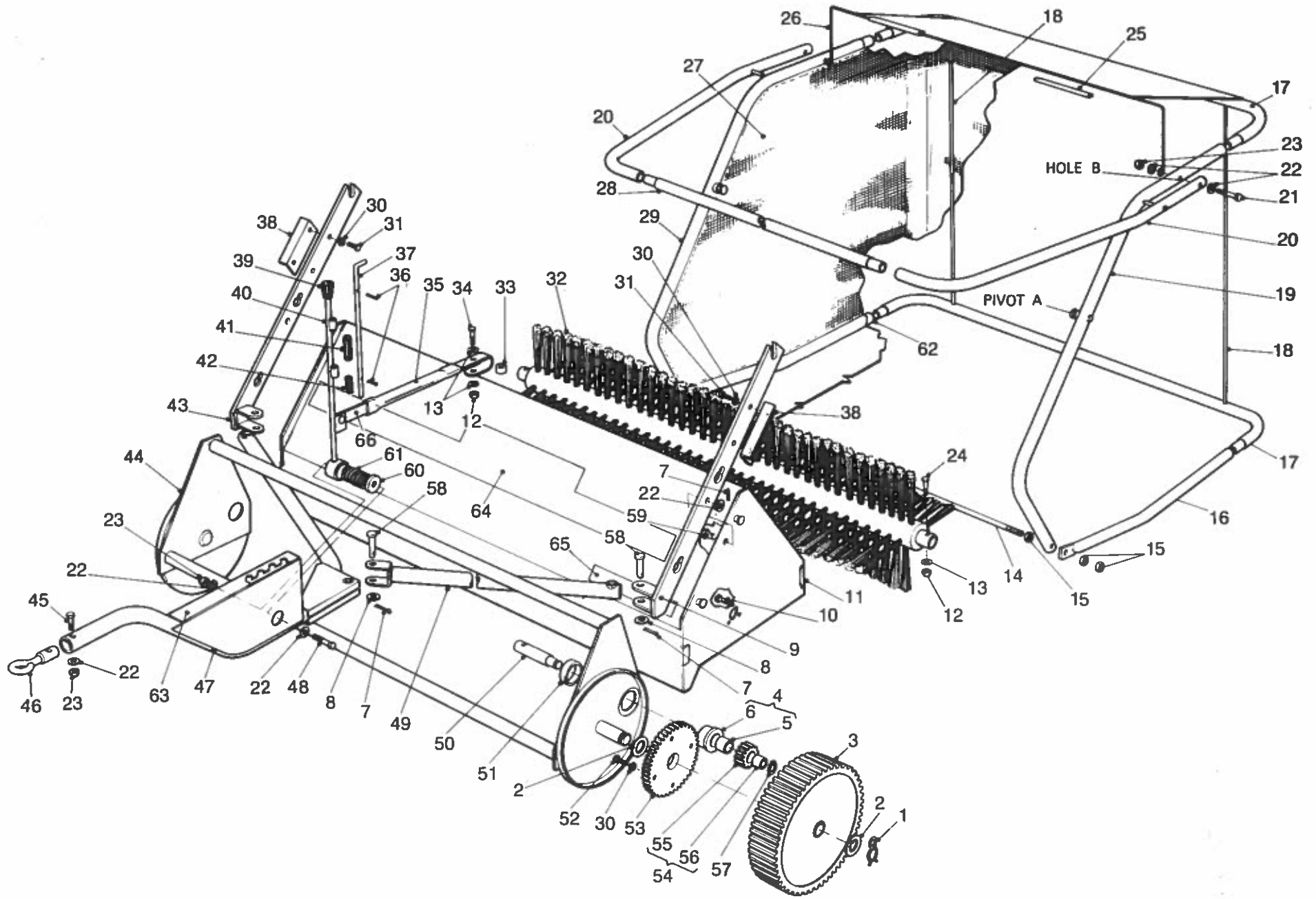

Item	Description	Part No.	Qty.
1	Wheel retaining clip	L05714	2
2	Washer	L05775	4
3	Wheel and tyre assembly (bushed)	L101188	2
4	Pivot spacer assy (includes items 5 & 6)	L32574	2
5	Bush	L32576	2
6	Pivot spacer	L32575	2
7	Split pin	L20901	5
8	M12 washer	L23209	3
9	Side support assy L.H.	L101168	1
10	M5 screw	L17589	6
11	Delivery box assy	L101166	1
12	M6 Nyloc nut – thick	L10074	3
13	Washer	L18129	4
14	Base support bar	L33263	1
15	M8 D/C nut	L18117	6
16	Base support L.H.	L101172	1
17	Rear support	L101174	2
18	Tie bar	L33259	2
19	Frame side assy L.H.	L101171	1
20	Handle side assy	L101175	2
21	M8 bolt	L11372	2
22	Washer	L11101	9
23	M8 Nyloc nut – thick	L11218	4
24	M6 screw	L11302	2
25	Plastic clip	L33275	2
26	Support wire	L33264	1
27	Grassbag	L33265	1
28	Handle crossbar	L101190	1
29	Frame side assy R.H.	L101170	1
30	M6 spring wsh	L18139	12
31	M6 screw	L18120	4
32	Brush assy	L33247	1
33	Spacer	L32551	1
34	M6 screw	L22702	1
35	Connecting bar S/A	L101187	1
36	Split pin	L04710	2
37	Selector release bar	L33228	1
38	Frame stop	L101169	2
39	Plastic knob	L32549	1
40	Selector arm W/A	L33224	1
41	Rubber tube	L33229	1
42	Spring	L33227	1
43	Side support assy R.H.	L101167	1
44	Wheel guard assy	L101165	1
45	M8 bolt	W25673	1
46	Towing eye assy	L32600	1
47	Selector draw bar assy	L101163	1
48	M8 Bolt	L11386	1
49	Draw bar assy L.H.	L101164	1
50	Drive axle	L32608	2
51	Spacer	L32617	2
52	M6 screw	L33047	8
53	Gearwheel	L33252	2
54	Pinion assy (includes items 55 & 56)	L32609	2
55	Pinion	L32610	2
56	Bearing	L32611	2
57	Circlip	L32612	2
58	Pivot pin	L32607	3
59	Side pin	L32566	2
60	Spring cup	L22614	1
61	Spring	L32550	1
62	Base support R.H.	L101173	1
63	Transfer – height adjustment	L32623	1
64	Transfer – Atco	L33266	1
65	Transfer – lawnsweeper	L32619	1
66	Selector arm rivetted assembly	L33223	
	comprises the following:–		
	Washer	L11101	1
	Rivet	L32547	1
	Selector arm welded assembly	L33224	1
	Connecting bar assembly	L33230	1

Charles H. Pugh Limited,
Sunnyhill, Derby, England. DE3 7JT.
Tel. 0332 (Derby) 760202 : Telex: 377514

Printed in England

L24316

AMENDMENT SLIP FOR MK II ATCO SWEEPER.

Please note that a modification to the handle assembly has been introduced, the new assembly method can be seen below:

